



VIDEO DOORBELL

SETUP &
INSTALLATION
GUIDE

Welcome!

Thanks for choosing iseeBell product.

If you need extra help, iseeBell Support Team is available 24/7.

And you can access our online resources anytime at: support.iseebell.com

Contact iseeBell Support Team directly at :

support@iseebell.com

VIDEO DOORBELL

Meet the front and back of your iseeBell

Front

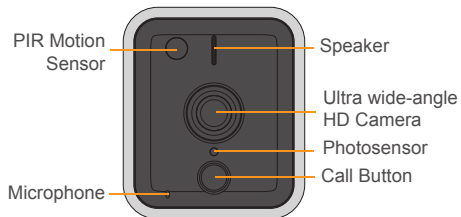

Back

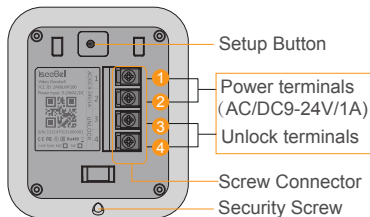

Wall Bracket

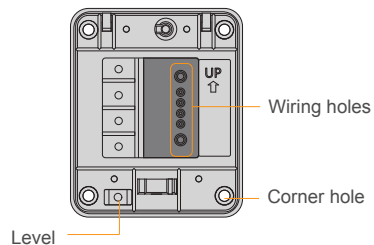

VIDEO DOORBELL

What's in the box



Wi-Fi Video Doorbell

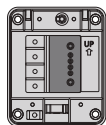

Wall bracket

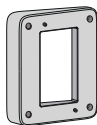

Wedge bracket

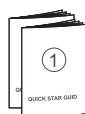

Quick start guide



Indoor Chime

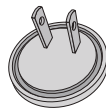

AC wall adapter

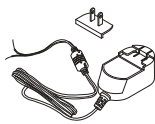

AC power adapter



Tool kit

Before you start

- Set it up indoors before mounting it outside.
- If you're installing on concrete, brick, or stucco surface, get a power drill ready.
- Do not install iSeeBell on a metal surface as it may block and/or weaken the Wi-Fi signal.
- IseeBell works well with standard U.S. doorbell wires. And make sure to complete the Step 6 in this manual.
- If you don't have existing wires or you want to use iseeBell as an indoor security cam, we've included an AC power adapter (input 100-240V) in the box.
- You can still choose to run new wires, as long as the operation output voltage to iseeBell is 9-24V AC/DC.
- IseeBell Video doorbell supports 2.4 Ghz Wi-Fi network only. Please switch your mobile device accordingly if it connects to a 5Ghz network.
- Move your router close to your iseeBell if your Wi-Fi signal is weak, or invest in a Wi-Fi extender.

VIDEO DOORBELL SETUP

Step1 Download the iseeBell App

Download the iseeBell app from the App Store® or Google Play™.
Open the app and tap "CREATE ACCOUNT" to create an account.



IOS 8.0 or above

Android 4.4.0 or above

- ❗ iseeBell only supports 2.4Ghz Wi-Fi network. If you are connecting to a 5Ghz network, switch it to a 2.4Ghz instead.

Step 2 Power it up indoors first

- Connect the wires of the power adaptor to the power terminals on the back of iseeBell Video Doorbell. It doesn't matter which wire connects to which screw.
- Plug the power adaptor to a wall outlet (100-240V).
- The front Call button lights up.

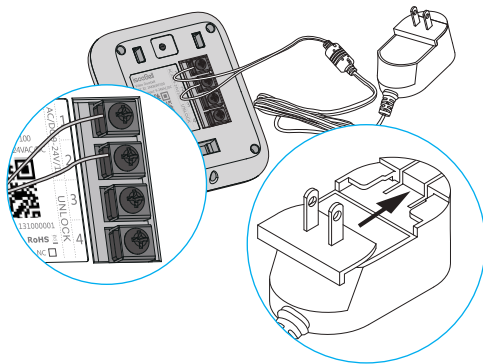

VIDEO DOORBELL SETUP

Step 3 Perform the in-app setup

- Log in to the iseeBell App.
- Select the plus sign to set up a new device. You will need your Wi-Fi network name and password.
- As much as is possible, try to perform the setup near your router.
- It may take a little while for iseeBell to upgrade to its latest firmware version. Power cycle the device and try again if setup fails multiple times.

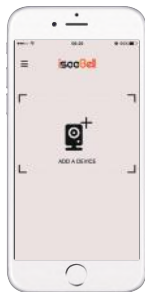

Step 4 Run a test and set up the iseeBell Indoor Chime

- Plug in the Indoor Chime.
- After setup, run a test by touching the front button on your iseeBell doorbell indoors near your router to view video.
- Then test the doorbell outside.
- If the outside doorbell video quality is not as good as the indoors, you may need to move your router closer to the door, or buy a Wi-Fi extender.



- ! It is a good time to pair the Indoor Chime with your Video Doorbell while it is still indoors (refer to the Indoor Chime Setup Guide).

VIDEO DOORBELL INSTALLATION

Step 5 Remove Your Existing Doorbell

- If you're replacing a wired doorbell, turn off the power at the breaker first.
- Remove doorbell from the wall.
- Disconnect the wires.

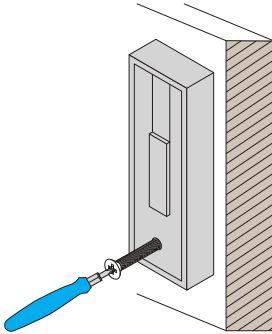

Step 6 Jumper connect your mechanical chime

- Locate your old mechanical chime inside your house. Normally, it's a white box on a wall.
- Take off the cover of your mechanical chime.
- Use the Jumper Wire provided to connect to "front" and "trans" screws.
- Put the cover back.

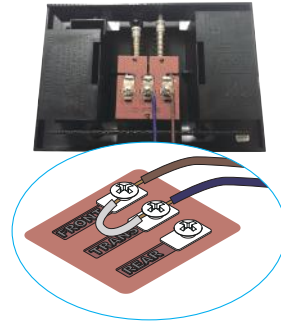

- ! This step is required if you have a mechanical chime.
For more info, go to support.iseebell.com and search "jumper".

VIDEO DOORBELL INSTALLATION

Step 7 Install Wall Bracket

- First, pierce the rubber of the wall bracket through wiring holes using your doorbell wires.
- Use the bracket and the small level as a template to position.
- Mark the four corner holes.
- On stucco, brick, or concrete install the anchors using a power drill and the drill bit provided.

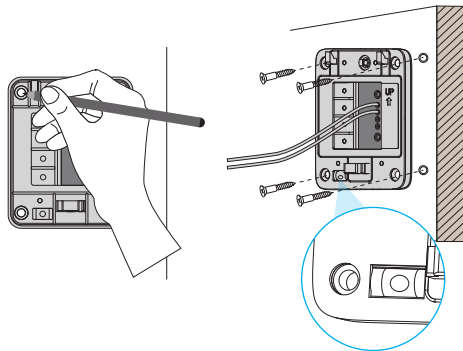

- Drive the screws into the anchors, or directly into your wall until they are flush with the Wall bracket, and the bracket is flat against your wall.
- On wood or siding, you can screw directly into your wall.
- Use the Phillips-head end of the iSeeBell screwdriver to screw in your Wall bracket.

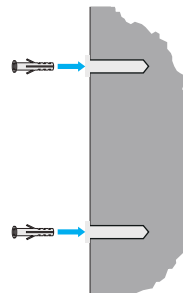

VIDEO DOORBELL INSTALLATION

Step 8 Install Wedge Bracket (Optional)

In a Wedge bracket, you will find:
two short screws
two long screws

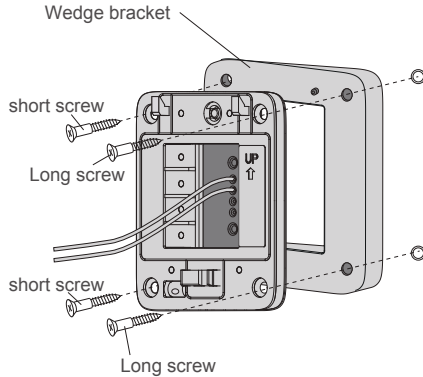

Step 9 Connect wires to iseeBell

- Connect wires to the power terminals on the back of iseeBell in any order.

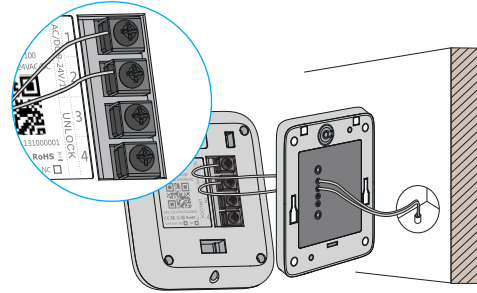

- ❗ Your new wiring must be connected to a power supply voltage of 9-24 V AC/DC, 1 Amp if you don't have existing doorbell wires.

VIDEO DOORBELL INSTALLATION

Connect wires to iseeBell (continued)

- If you cannot connect the wires to the screws directly, use the accessories we provided.

Black:
Extra Wire
(fork end)

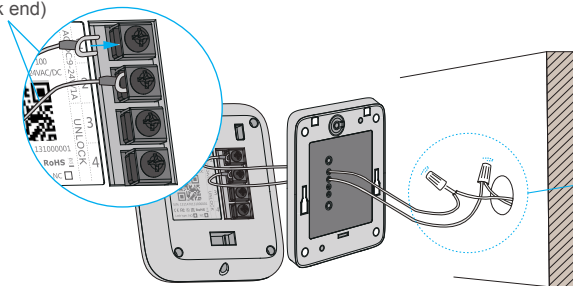

- Connect the extra wire with the fork end to one power terminal.
- Hold the extra wire and your doorbell wire ends together, cap them with a wire nut and twist clockwise until secure. Do the same with the other power terminal.

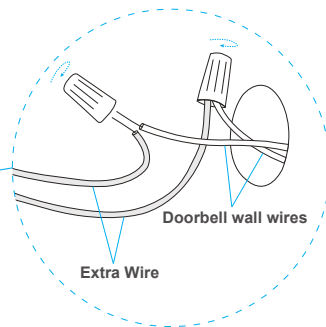

3/8"
the exposed wire
should be straight.

VIDEO DOORBELL INSTALLATION

Step 10 Attach your doorbell to the bracket

- Line up the holes in your iseeBell Doorbell with the slots on the bracket.
- Push firmly towards the wall.

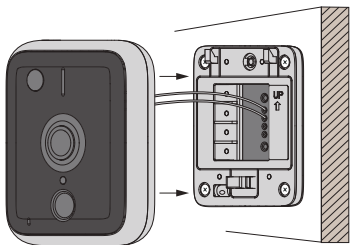

Step 11 Secure Your iseeBell Doorbell

- Use the star-shaped end of your iseeBell screwdriver to tighten the security screws on the bottom of your iseeBell Doorbell.
- Then restore power at the breaker.

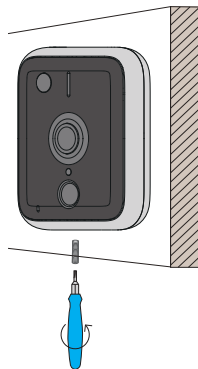

VIDEO DOORBELL

Step 12 Connect iseeBell to your lock (optional)

If you need to connect your lock to iseeBell Doorbell, follow the wiring diagram and connect required wires to Lock terminal screws.

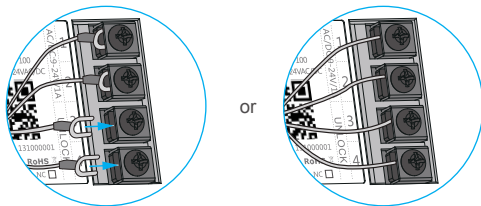

VIDEO DOORBELL

Access Control System Wiring Diagram

a. Normally Open (NO), e.g. Electric Strike

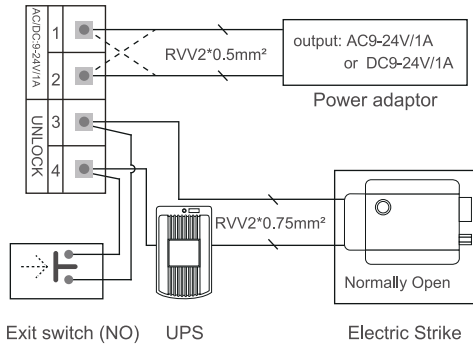

b. Normally Closed (NC), e.g. Magnetic Lock

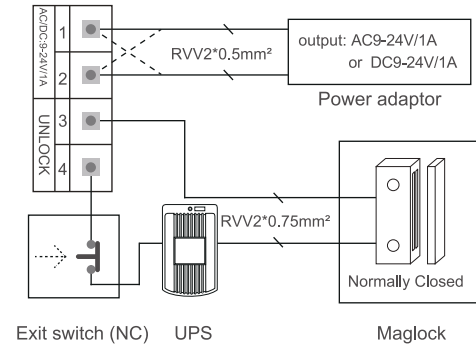

Enjoy your iseeBell Video Doorbell

Thanks for helping to make you and your family safer.